

# CERTIFICATE OF LOCATION OF GOVERNMENT CORNER

NORTHEAST Corner of Section 20, Township 105, Range 43, 5TH P.M.

STATE OF MINNESOTA, County of MURRAY

At the corner location shown on the sketch:

On 10-21-2008 found a CONCRETE MONUMENT  
DATE

left monument as found,  lowered monument,  removed monument (explain)

On 10-21-2008 placed a 5/8" IRON WITH SEAL #43844 ON NORTH AND SOUTH  
DATE  
SIDES OF MONUMENT

### SKETCH OF REFERENCE TIES

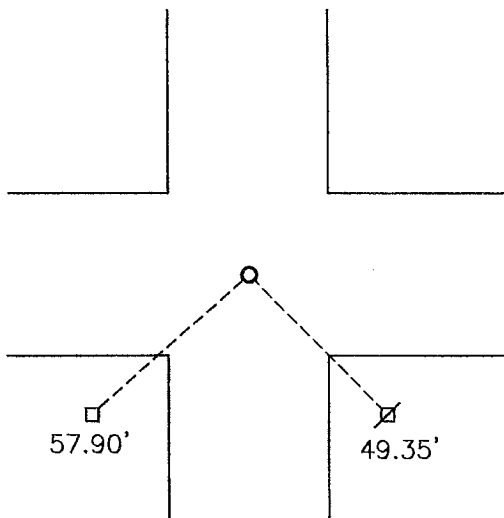

Minnesota State Plane Coordinate  
System Murray County Datum  
NAD83 (1996)

N: 116300.014  
E: 432104.687

Nail and seal in guy pole SW 57.90'  
Nail and seal in power pole SE 49.35'

Statement of evidence relative to this corner location is on back of page.

I hereby certify that this document and the data contained herein was prepared by me or under my direct supervision.

*James V. Johnson* 3/5/09  
SIGNATURE DATE

Registration No. 43844

Land Surveyor,  Professional Engineer  
 County Surveyor,  County Engineer

OFFICE OF THE COUNTY RECORDER  
County of

I hereby certify that this document was filed in the Co. Recorders office at \_\_\_\_\_ .M on the \_\_\_\_\_ day of \_\_\_\_\_ A.D. 20 \_\_\_\_\_

County Recorder *James V. Johnson*  
By \_\_\_\_\_, Deputy

DOCUMENT NO. JUL 10 2009

## Statement of Evidence

In 1866, J. W. Bishop did the original subdivision of the township.

On June 19, 1913 a stone was recorded at the corner.

On October 21, 2008, Bueltel-Moseng Land Surveying dug with a backhoe and found a 6" round concrete monument 7" below surface. We placed  $\frac{5}{8}$ " irons with seal #43844 on the north and south sides of the monument.